

UNIT 3

**ONE SIX
SEVEN**

**HAWTHORN
STREET**

GLASGOW G22

TO LET

**9,644 SQ FT (895.9 SQ M)
RETAIL WAREHOUSE**

- / Competitive terms available
- / Part of established retail complex
- / Highly visible location with passing trade
- / Close to extensive residential area
- / Existing occupiers include:

farmfoods



UNIT 3 ONE SIX SEVEN HAWTHORN STREET GLASGOW G22

Glasgow is Scotland's largest city with a resident population exceeding 600,000 and a significant broader catchment.

167 Hawthorn Street is located within the Springburn area, which lies approximately 3 miles north of Glasgow City Centre.

The unit forms part of a single storey three unit complex, with good frontage onto Hawthorn Street and benefits from customer parking to the front and dedicated delivery access to the rear.

Buzz Bingo is an established occupier, with Unit 2 recently let to Farmfoods.

Ashfield Train Station and numerous bus stops serve the site and all lie within minutes walk of the unit.

Neighbouring occupiers comprise a mixture of retail, trade and light industrial, including B&M Retail, Home Bargains and Lidl.

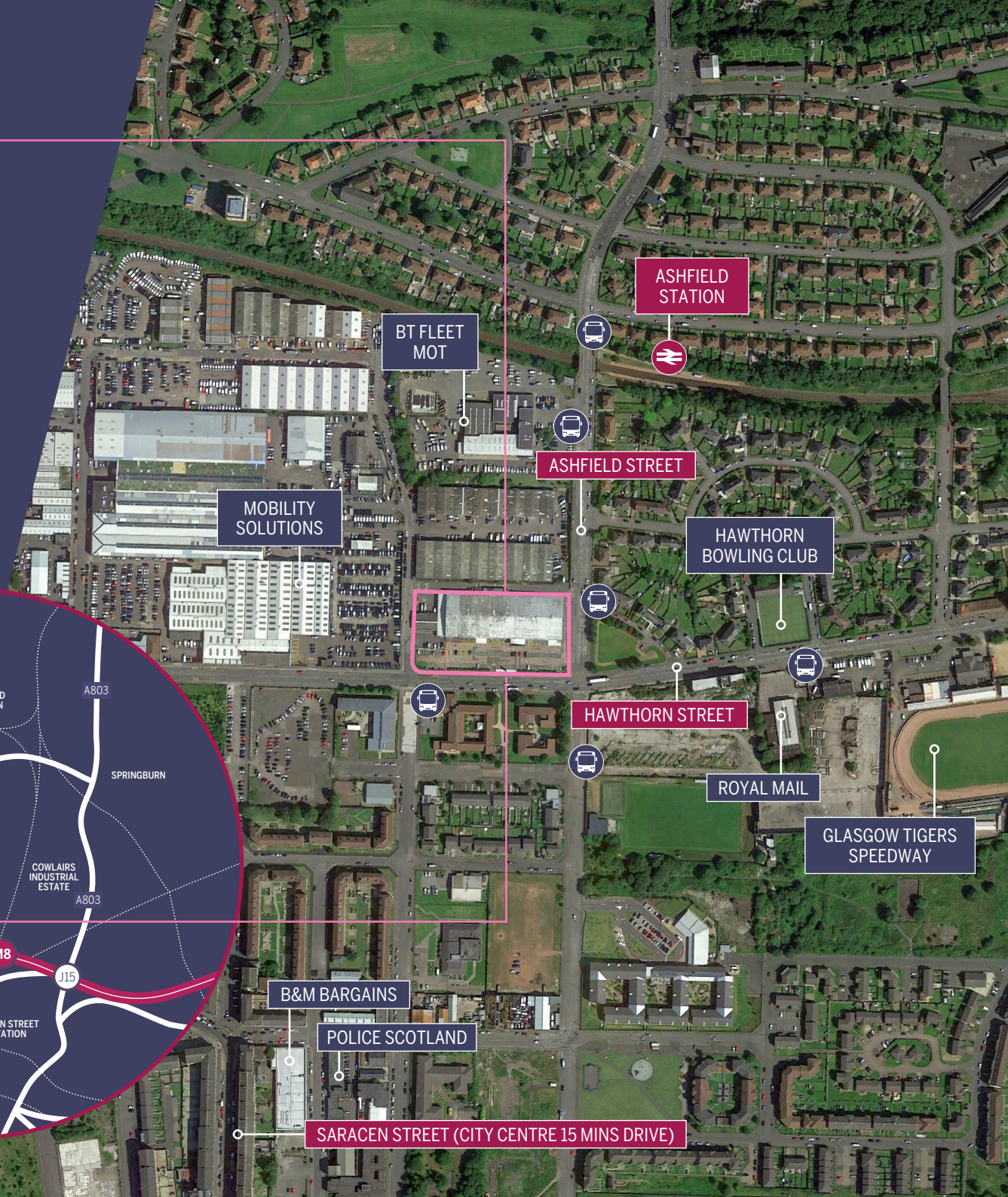

UNIT 3

ONE SIX
SEVEN

HAWTHORN
STREET

GLASGOW G22

ACCOMMODATION

Completed to a shell specification the areas and dimensions are as follows:

Frontage	79' 8"	(24.3 m)
GIA	9,644 sq ft	(895.9 sq m)

LEASE

The premises are to be offered to the market on FRI terms for a minimum period of 10 years, subject to 5 yearly rent reviews.

RENT

Offers invited – terms upon application.

RATES

The subjects are yet to be assessed.

PLANNING

The premises currently enjoy a Class 11 Leisure Use. It is envisaged change to Class 1 Retail will be positively received.

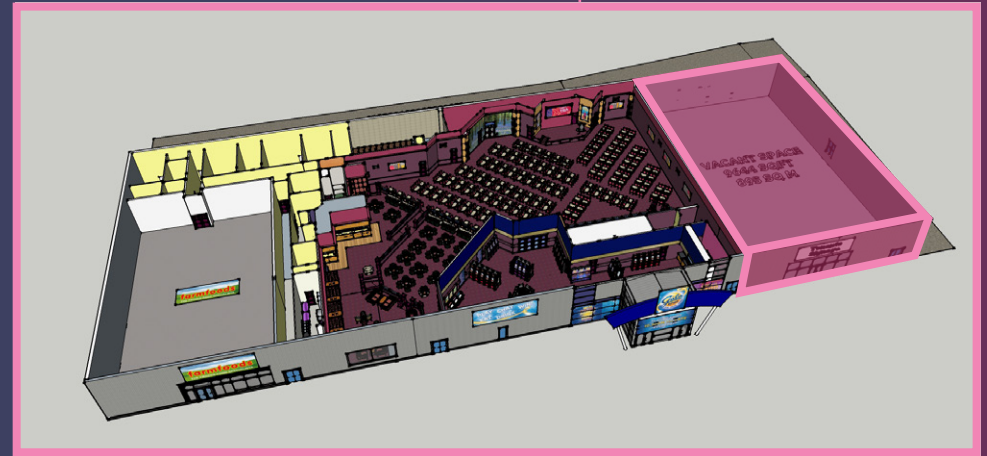

TO LET

9,644 SQ FT (895.9 SQ M)

RETAIL WAREHOUSE / LEISURE UNIT



UNIT 3
ONE SIX SEVEN HAWTHORN STREET
GLASGOW G22

ENERGY PERFORMANCE CERTIFICATE

To be commissioned following occupancy.

LEGAL COSTS

Each party is to be responsible for their own costs.

ENTRY

Upon conclusion of legal formalities.

MONEY LAUNDERING REGULATIONS

To comply with Money Laundering Regulations we are legally required to undertake due diligence on prospective purchasers /tenants which will at a minimum include proof of identity /address and funding. Applicable documentation will therefore be required on agreement of Heads of Terms.

VAT

All the terms are quoted net of VAT where applicable.

VIEWING & FURTHER INFORMATION

All arrangements to view must be made through the sole agents.

wbf.
whitelaw baikie figes
0141 221 6161
www.wbf.co.uk

Graham Figes
graham@wbf.co.uk
0141 221 6161

81 St Vincent Street
Glasgow G2 5TF

Misdescriptions. The information contained within these particulars has been checked and unless otherwise stated, it is understood to be materially correct at the date of publication. After these details have been printed, circumstances may change out with our control. Whitelaw Baikie Figes for themselves and for the vendors of this property whose agents they are give notice that: i) the particulars are set out as a general outline only for the guidance of intending purchasers or lessees, and do not constitute part of an offer or contract ii) all descriptions, dimensions, references to condition and necessary permission for use and occupation, and other details are given without responsibility and any intending purchasers or lessees should not rely on them as statements or representations of fact but must satisfy themselves by inspection or otherwise as to the correctness of each of them and are advised to do so. iii) no person in the employment of Whitelaw Baikie Figes has any authority to give any representation or warranty whatsoever in relation to this property. iv) all prices, rent and premiums quoted are exclusive of VAT at the current rate. v) any rateable values quoted have been supplied by reference to the relevant local rating authority. Interested lessees are advised to satisfy themselves as to their accuracy. October 2019.